

Installation Guide of WiiLSW - The Manhole Cover Sensor

(simple version)



1. Preparation

Other than the manhole cover sensor, you will need tools like wrench, screwdriver, hammer, drilling(M10), pick mattock, etc.



2. How to install

(1) The installation positions

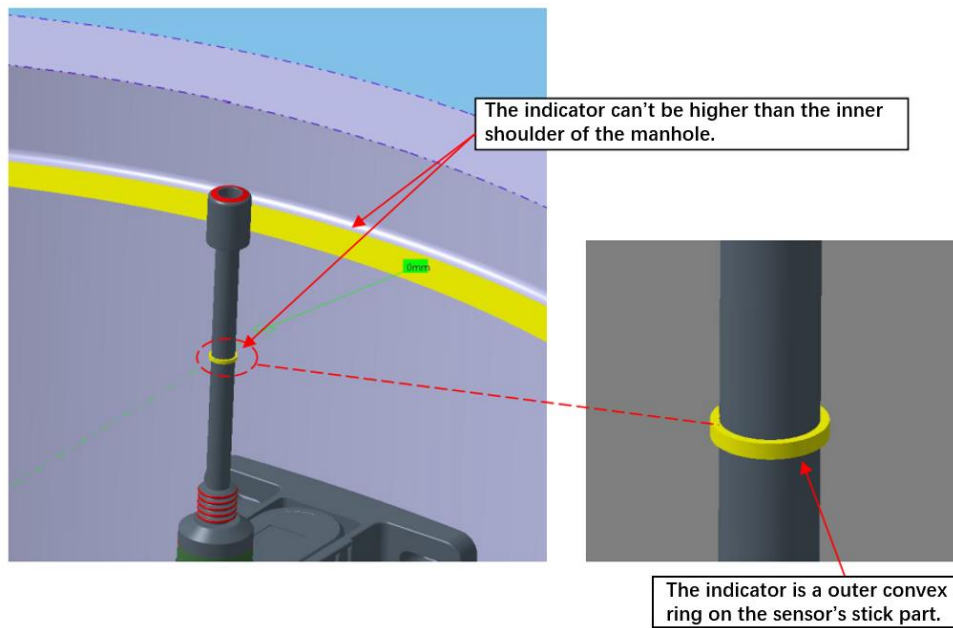
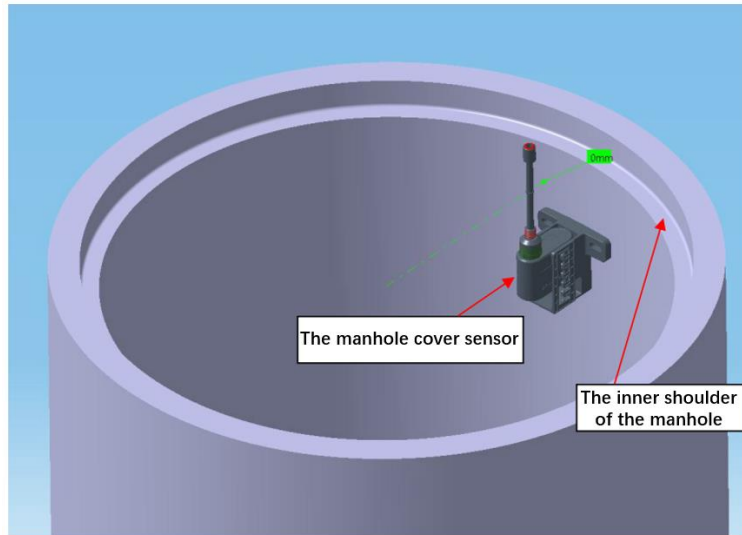

(2) The manhole cover placement

The right way: the manhole cover is placed slowly and vertically downward to the manhole. (see figure 1 below)

The wrong way: the manhole cover is placed sideling downward to the manhole, or the manhole cover is pushed horizontally to the manhole. (see figure 2~4)

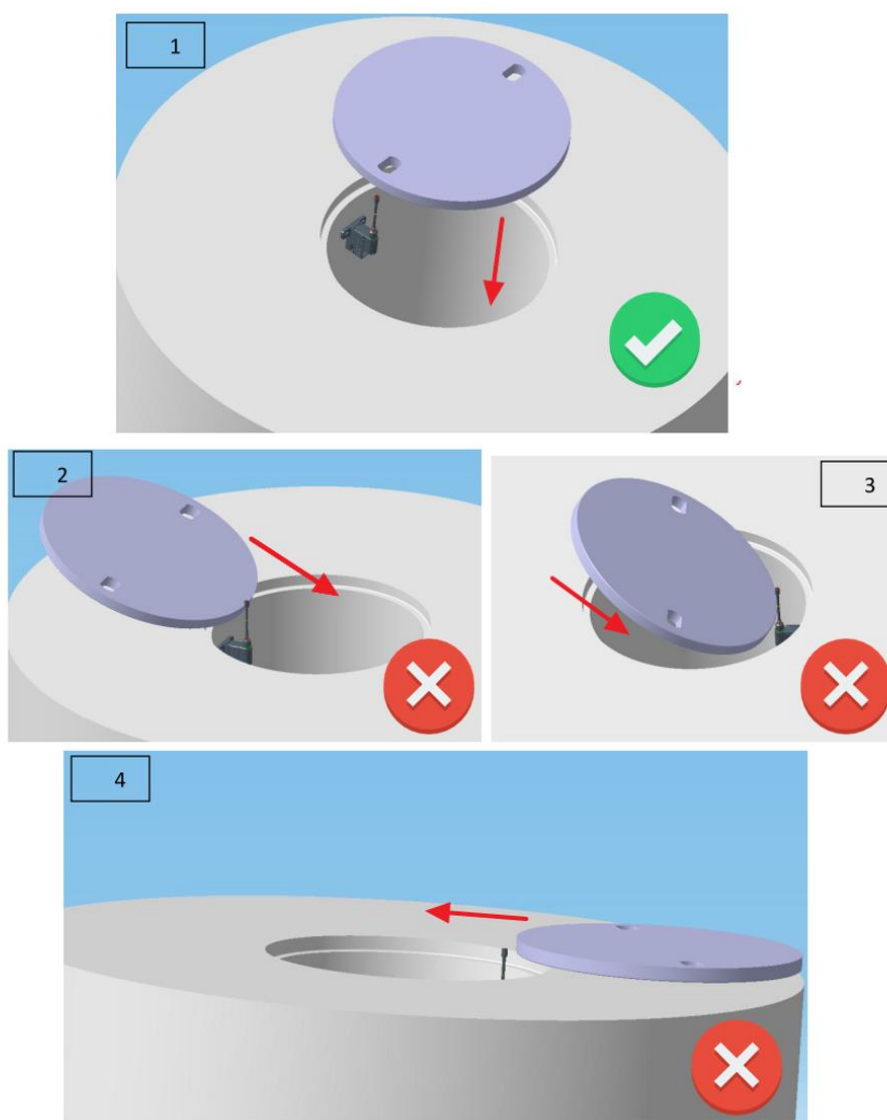

(3) Simulation of the product after it being installed

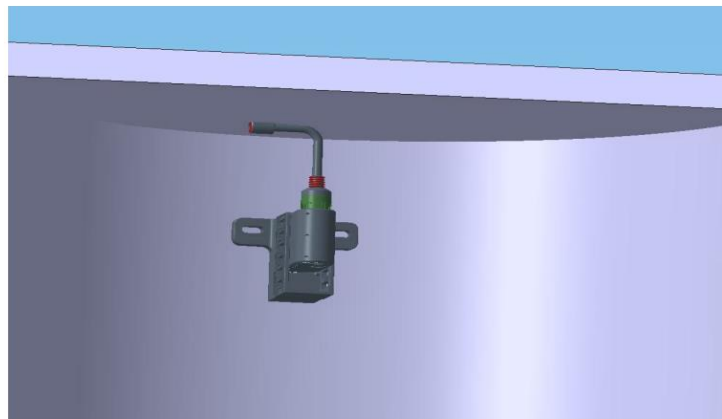
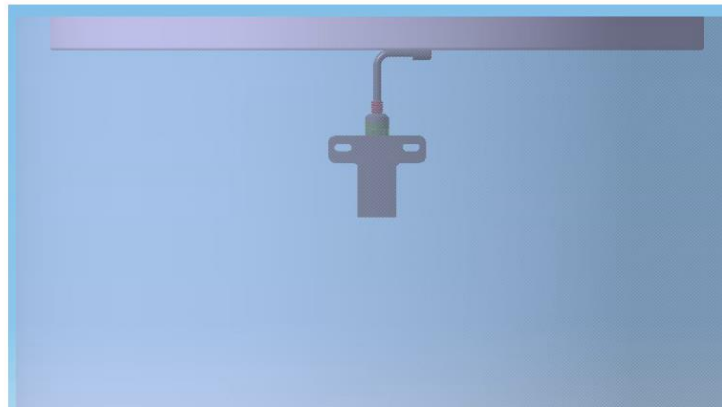

3. Device registration

The software is accessible from WeChat APP (WeChat is a famous Chinese chatting APP, it is also a programming platform that developers could develop their own APPs on it).

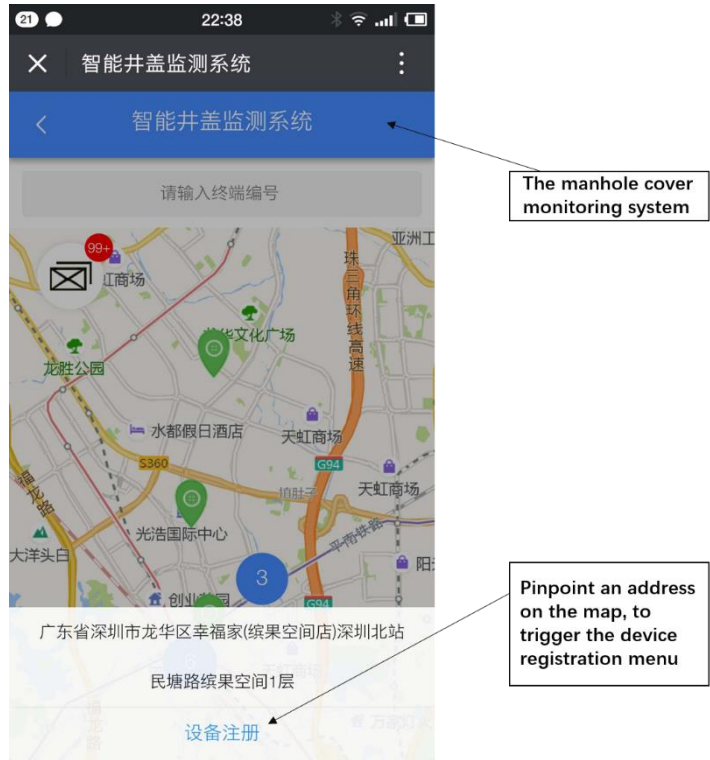

4. Software demo (besides the device registration function)

(1) The main entry

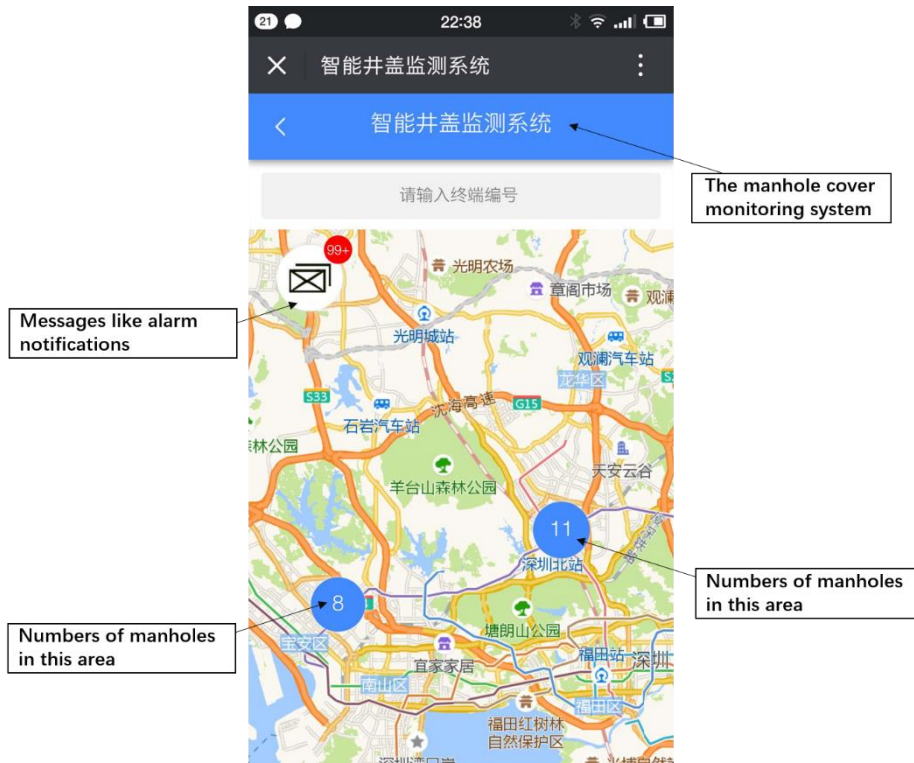

(2) See one manhole's info

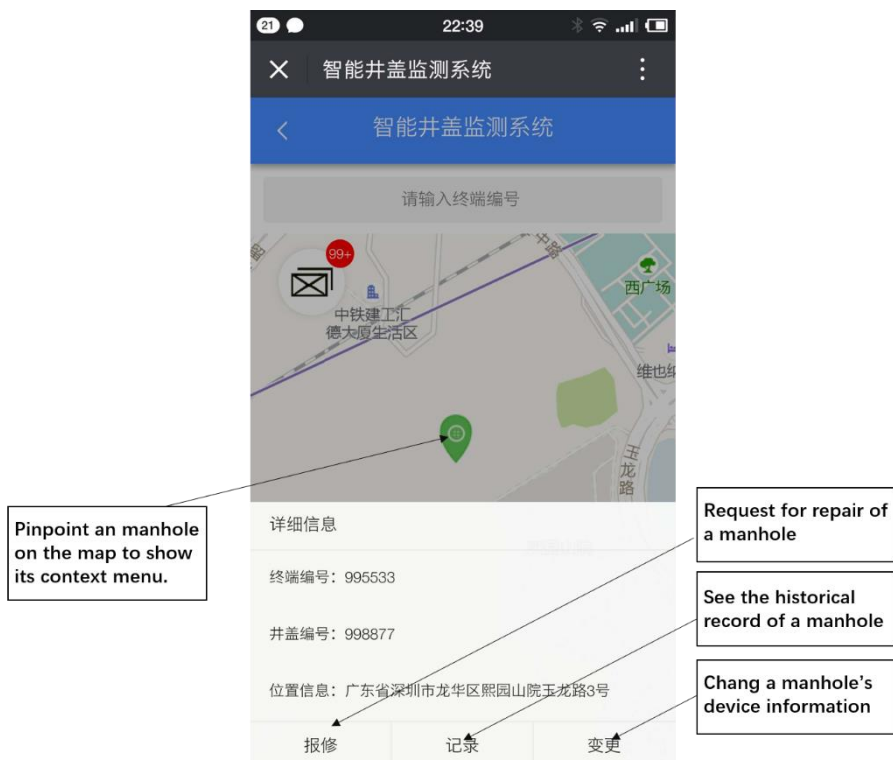

(3) The message inbox

